

Meet Your New

# Encore

LITE



\*Images may vary from the actual product.



# It's All About Taste

At Cafection, we strive to deliver nothing less than a perfect cup of coffee, anywhere, at anytime. That is why every day, we work to build the greatest coffee experience, starting with fresh coffee perfectly ground using the highest quality burr grinder and brewed through a French press design. Our machines' customizable beverage options help you create the best taste possible!

- Adjustable gram throw guaranteeing a constant taste profile.
- On-screen beverage settings to let the customer order his perfect drink.
- Choice of close to a hundred of sizes and strengths recipe combinations.



...and much more!

# Low-Carbon Lifestyle

## Be One of Those Making a Greener Planet with Cafection

### Only Compostable Wastes

- No plastic cups in the landfill.
- 100 % compostable organic coffee waste.
- Biodegradable filter paper.

### Reducing Greenhouse Gas Emission

- Remote monitoring & management using Sophia - Global Management System.
- Maintenance notifications to reduce service visits and be PROACTIVE.
- Save time and money while making a difference at a larger scale by reducing your environmental footprint.

### Other Sustainable Advantages Offered by Cafection

#### Energy Saving Mode\*:

- Brewers are asleep around 74% of their lifetime, mostly on weekends, holidays and at night\*\*.
- Set sleeping periods to reduce energy use.
- Machines can be woken up at anytime. Water is kept at the ideal temperature to minimize heating time and to guarantee safety.
- Increase significantly the lifetime of all components in contact with water.

Sophia  
Global Management System

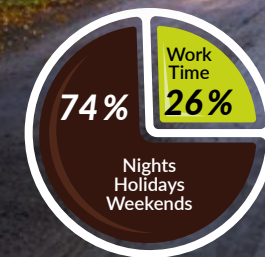

\*Available on Cafection's web-based application, Sophia – Global Management System. Optimum license required.

\*\*Based on 8 am to 5 pm work days.



# Connectivity

## Peace of Mind, Remotely

### Now Connected Via a Cellular Modem

- Private and secure network
- Faster connection
- Automatic updates pushed remotely\*

### Easy Cellular-Connected Management

- Remote maintenance notifications\*
- Online ordering process\*

### Exclusive Software Features

- Energy saving schedules & screen saver\*
- Push videos to the screen\*
- Preprogrammed rinse and valves self-cleaning features

### What is Sophia - Global Management System?

*Sophia is a web-based application for easy management and monitoring of your different assets. New features and management possibilities for you to reduce service calls and to offer excellence, cup after cup.*

The new 3.0+ software is compliant with

**Sophia**  
Global Management System

# The Machine

## Features & Innovations

### Elegant Design

- New executive look designed with your space in mind
- Multiple color choices to fit your coffee area

### Quieter

- Smoother grinding process (high quality grinder)
- Noise reducing inside panel

### Easier to Fill

- 10 lb capacity bean hopper, with a choice of 3 different coffee roasts
- Choice of 2 solubles: hot chocolate & French vanilla or milk
- Mess-free filling system for solubles
- Lockable products compartment for your safety

### Customization Options

- Display promo videos during the brew time\*
- Add your logo and tagline to the right part of the screen saver\*
- Upload the logo of your favorite roasters to display on the beverage settings screen\* and set the recipes to meet the high quality taste profile

### Easy to Install

Everything in a single box: unpack, plug and enjoy!

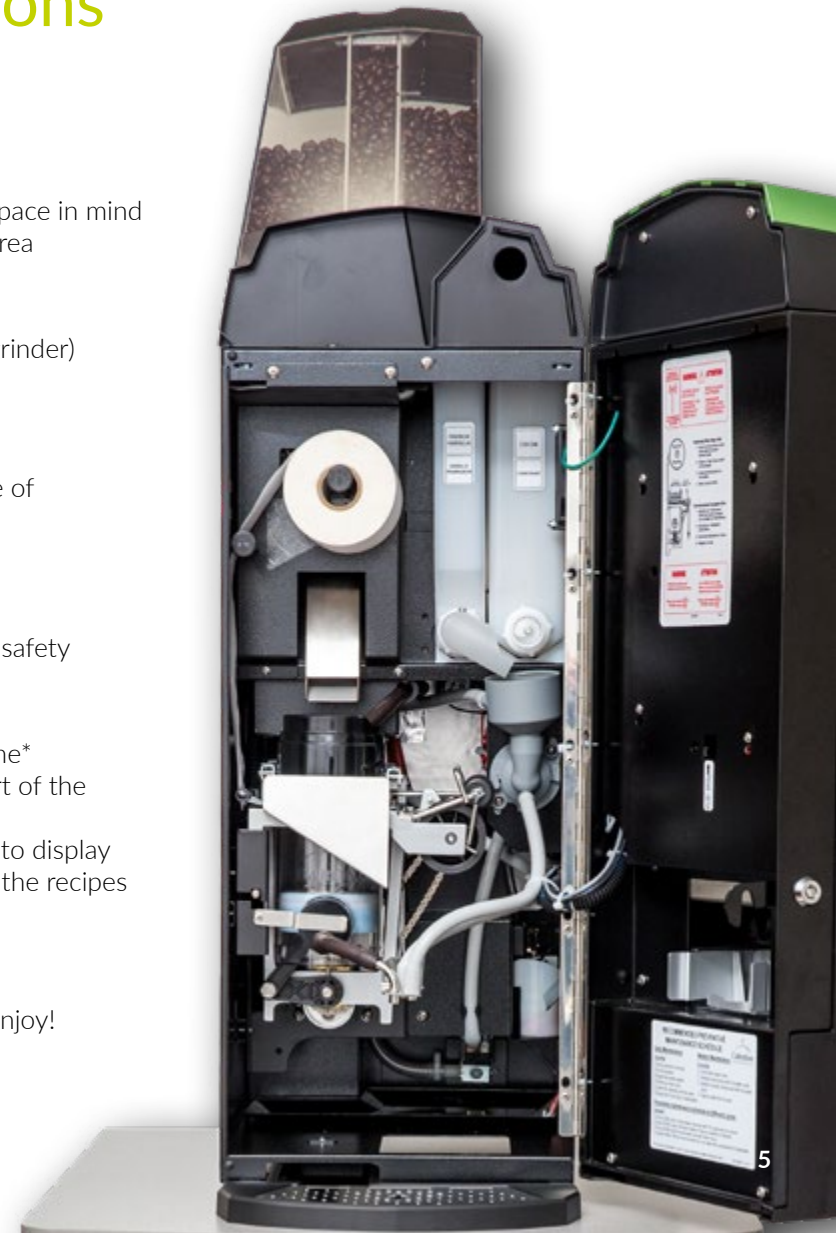

# Intuitive User Interface

## In Colors That Match Your Brand

### Selection Screen

Easily recognizable images for each beverage showing the recipes' content.

Maintenance notifications on screen.

### Coffee Names Customization

Ability to customize coffee names (up to 26 characters on a maximum of 2 lines) and roaster tags\*.



### Beverage Settings Screen

Simple selection screen to customize your perfect beverage.

Add milk (up to 2), modify strength: watch the regular coffee image displayed change.

### State of the Art Technology

Enhanced user experience through an intuitive and improved touchscreen technology.

Customizable screen in 3 colors (blue by default) to match your brand image.





# Reliable Technology

## 20 Years of Expertise in Coffee Machines Manufacturing

- *Founded in 1996.*
- *Largest bean to cup coffee machine manufacturer in North America.*
- *More than 2 billion cups of coffee served over the years.*

## Cafection's Brew System

- *Patented reverse French press technology.*
- *Professional burr grinder for the perfect coffee, one cup at a time.*
- *Freshly brewed cup of perfect coffee, every time!*

## Cafection's Innovations & Exclusive Options

- *Internet-connected brewers that can be managed remotely.*
- *ADA compliant coffee machines.*
- *Larger brew group delivering a 24 oz cup of coffee in a single brew cycle (available on the Encore Venti).*

## Improved Soluble Whipping System

- *High-speed whipping disk for an optimal mixing of soluble drinks.*
- *Thicker foam for a perfect milk on top of your gourmet coffee.*
- *Barista quality froth.*

# Options & Accessories

## Equip Your Machine

### Accessories

- *Cup & condiment dispenser*
- *Wood base cabinets*
- *Chute kit (for coffee waste)*

### Connectivity

- *Sophia Optimum license*

### Space Improvement Options

- *Drawer kit*
- *Extended base (fits a mug of 9")*

### Integrated Option

- **ADA compliant touchpad:**  
*An adapted keyboard to help people who are not able to reach the screen or are not comfortable using it to order coffee. Also compliant with the Americans with Disabilities Act (ADA).*

### Vending Options

- *Coin mechanism & coin kit*
- *Bill acceptor & bill box*
- *Credit card reader*





# Customization

## Brewing Time Video Branding

Take advantage of the 1-minute brewing time to display videos to your customers. Promote your company services and products or send internal communications.

## Screen Saver Video Branding

Draw the customer's attention by displaying your own personalised videos in Screen Saver mode.

These 30 second videos will stimulate your customer's interest in your different products and services and will lead them directly to the coffee machine.

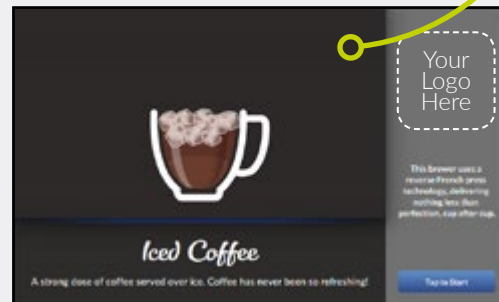

Videos can be pushed remotely using Sophia - Global Management System (Optimum license required).



## Fits Your Coffee Area

Default color of the Encore Lite machine is black. However, you can choose to swap the fascia of your unit to fit your break room or your brand image.

# Try it Today!

\*Default Color

# Technical Specifications

## Encore Lite - Made in Canada

### Description

- Fresh bean to cup coffee machine
- 3 bean hopper (3.7 lb, 2.3 lb, 3.5 lb)
- 2 soluble canisters (2.5 lb, 2 lb)
- 3 cup sizes
- 3 brew strengths
- 7" touch screen
- 3G cellular modem included
- 1,600 coffee capacity filter paper rolls

### Customizable Options

- Brew time and screen saver videos\*
- Roasters and OCS logos on screen\*
- Cup sizes & brew strengths
- Recipes settings & gram throw
- Beverages name & coffee tags
- Beverages description for screen saver\*
- Color theme of the interface

### Beverages Selection

- |                    |                                  |
|--------------------|----------------------------------|
| Coffee (3 choices) | <i>Vanilla Option (Default):</i> |
| Coffee 50/50       | Vanilla Coffee                   |
| Iced Coffee**      | Vanilla Choco                    |
| Hot Water          | Vanilla Choco Coffee             |
| Long Espresso      | French Vanilla                   |
| Energy Shot        | <i>Milk Option:</i>              |
| Hot Shot Blend     | Café Latte                       |
| Hot Chocolate      | Cappuccino                       |
| Mokaccino          | Choco Latte                      |

### Dimensions & Minimum Space Requirements

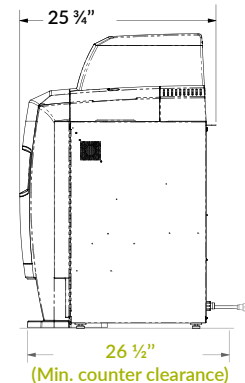
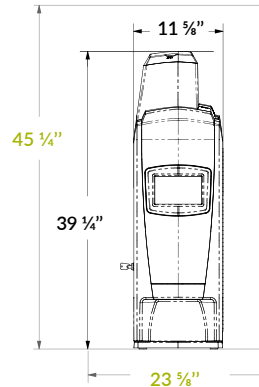

### Requirements

- Electricity:*  
120 VAC, 15 A, 60 Hz
- Water services:*  
plumbed or bottled
- Water tank capacity:*  
0.8 gal
- Weight:* 94 lb

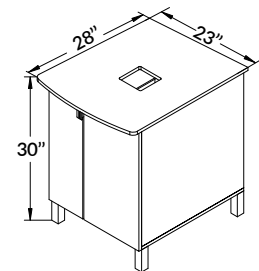

Assembled Wood Cabinet



\*Sophia license required. \*\*Ice machine required.



Proud member of the  
**EVOCA**  
GROUP

2355, avenue Dalton, Québec (Québec) G1P 3S3 Canada  
T: 800-561-6162 F: 800-463-2739  
[www.cafection.com](http://www.cafection.com)

